

# CH CLUBHOUSE<sup>®</sup> INN & SUITES

## Meeting & Conference Rooms

Whether you're hosting a business meeting, a family reunion, a holiday party or a special event, our hotel offers the perfect location and amenities for you! We can accommodate groups up to 50 people, with optional catering packages available. Our helpful, friendly staff and relaxing casual surroundings are just the right ingredients to ensure your event's success.

- o Very competitive rates
- o Garden courtyard
- o Club Lounge area
- o Free high-speed Internet access
- o Audio/visual equipment available
- o Ample parking
- o Complimentary water service
- o Storage available for your materials during your event
- o Shipping of your materials after your event

### Our Board Room

\$125 flat rate, daily

12 feet by 18 feet with:

- o A large oval conference table and 10 cushioned, rolling office chairs
- o A permanent white board (with cabinet doors, for when not in use)
- o Track lighting (with a dimmer switch) over conference table for more working light
- o DSL high-speed internet access and WiFi
- o A 27" television with built-in VCR
- o A mini-refrigerator
- o A microwave
- o Its own bathroom
- o An adjoining king bedroom

See other side for Terrace Room.

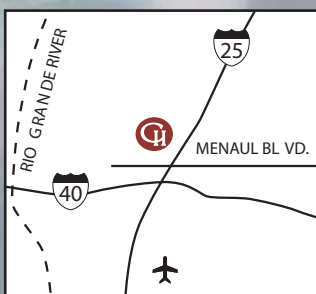

1315 Menaul Boulevard Northeast  
Albuquerque, New Mexico 87107  
Phone: (505) 345-0010 Fax: (505) 344-3911

866-345-0010 (Toll Free)  
www.albuquerque.clubhouseinn.com  
bconley@clubhouseinn.com

# **CLUBHOUSE**<sup>®</sup> INN & SUITES

Phone: (505) 345-0010  
 Fax: (505) 344-3911  
**866-345-0010** (Toll Free)  
[www.albuquerque.clubhouseinn.com](http://www.albuquerque.clubhouseinn.com)  
[bconley@clubhouseinn.com](mailto:bconley@clubhouseinn.com)

**Rental Rates:**  
 1 to 4 hours: \$125  
 4 to 8 hours: \$250  
 8 to 24 hours: \$375

## Our Terrace Room

is 20 feet by 28.6 feet with:

- o A permanent white board, with screen (with cabinet doors, for when not in use)
- o Variable lighting and blinds on the floor-to-ceiling bay windows for A/V needs
- o Wireless, high-speed internet access (if you do not use WiFi, DSL is available)
- o Double-door entry as well as a single-door side entry (allows for larger capacity, and the side door leads directly to bathrooms, phones and water fountain)
- o Business Center located just outside the meeting room, with computer (high-speed Internet) and printer available
- o A/V Equipment available: 40" x 40" front projection screens (2), TV with VCR or DVD with cart, LCD overhead projector, amplifying speaker, podium, and easels with pads and markers
- o Heating and cooling controls within room for maximum comfort

## Possible Room Configurations

### U-Shape

Maximum Capacity: 26

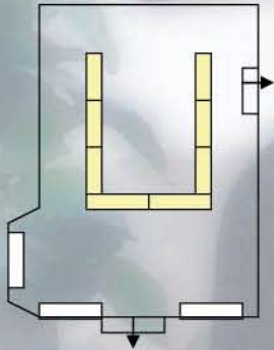

### Conference

Maximum Capacity: 28

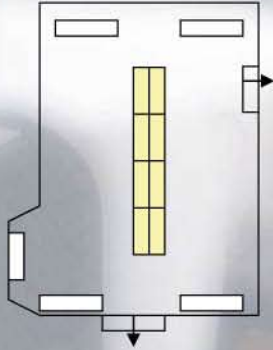

### Hollow-Square

Maximum Capacity: 34

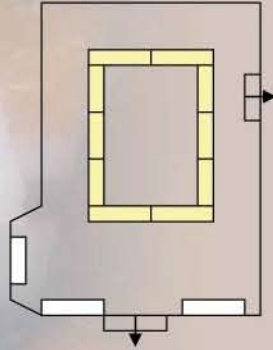

### Cafeteria

Maximum Capacity: 40

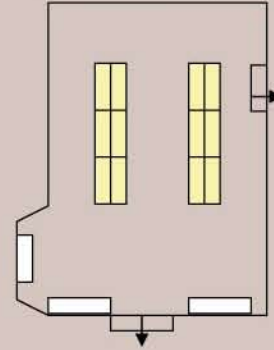

### Chevron

Maximum Capacity: 40

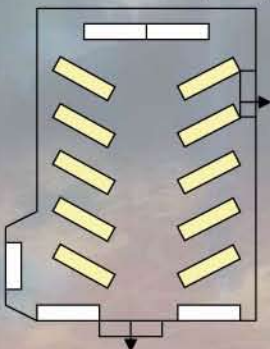

### Banquet

Maximum Capacity: 45

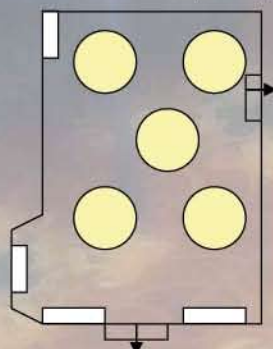

### Classroom

Maximum Capacity: 45

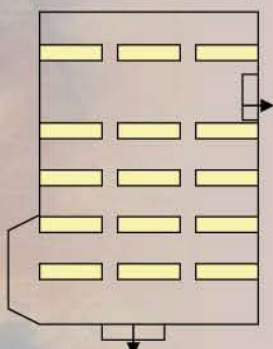

### Theatre

Maximum Capacity: 50

